

Underground Tank with Indoor Use & Drip Irrigation

Illustrations are for reference only, other components & designs are acceptable with the approval of Design Engineer and AHJ

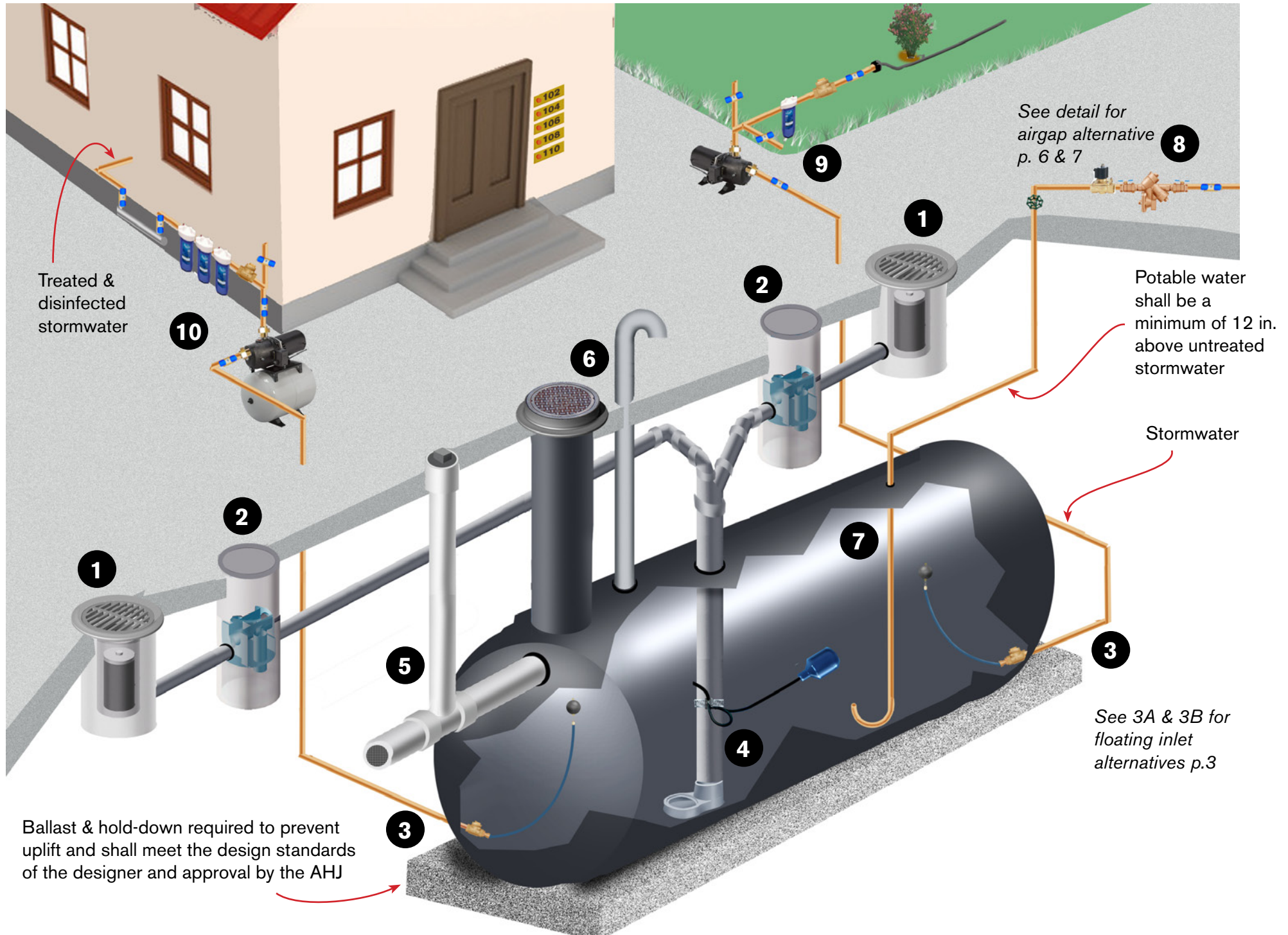

Underground Tank with Indoor Use & Drip Irrigation

Illustrations are for reference only, other components & designs are acceptable with the approval of Design Engineer and AHJ

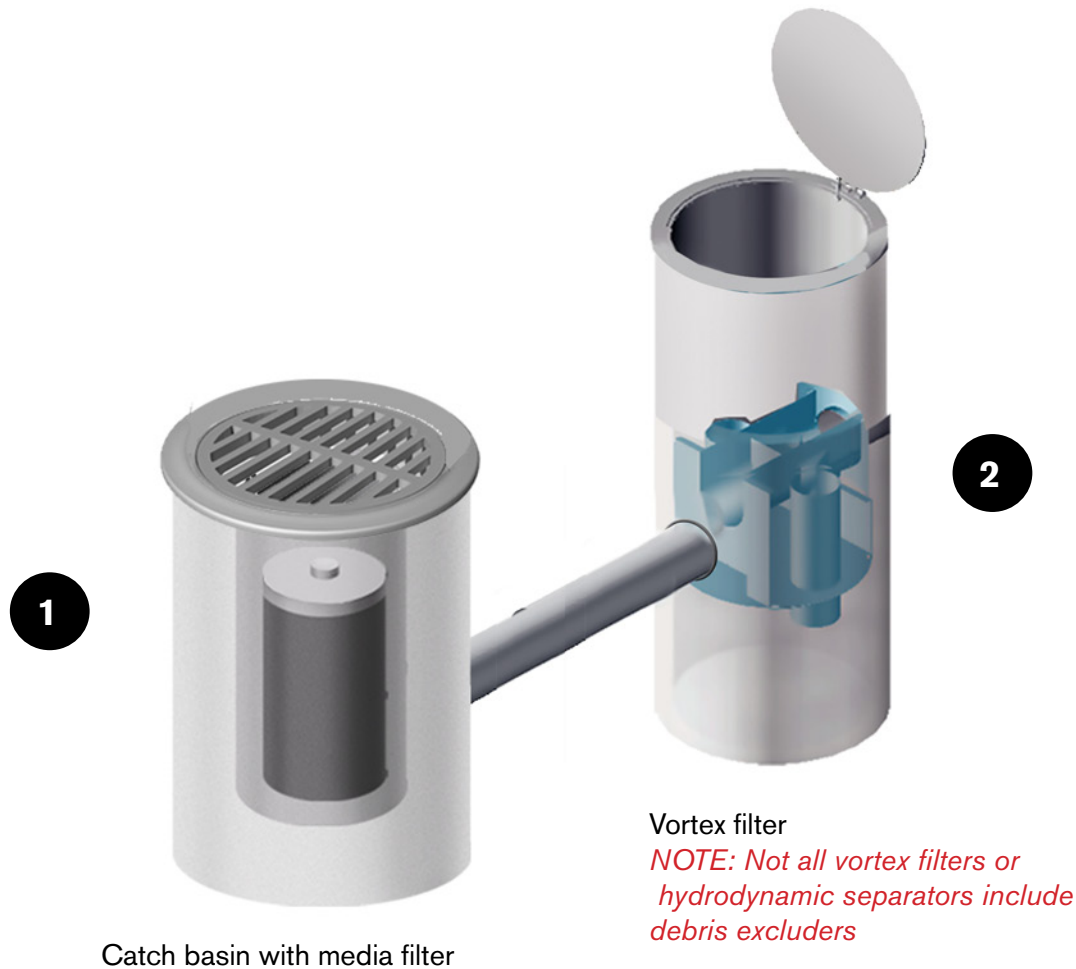

Connections to catch basins and vortex filters shall be through manufacturers' supplied and approved connections or shall be installed with watertight rings or grommets conforming to ASTM C 923 for concrete structures. Field applied PVC & CPVC bulkhead fittings shall conform to ASTM 1784. Polypropylene bulkhead fittings shall conform to ASTM D 4101.

Underground Tank with Indoor Use & Drip Irrigation

Illustrations are for reference only, other components & designs are acceptable with the approval of Design Engineer and AHJ



Floating suction inlet with bronze check valve. Check valve acts as a foot valve to maintain prime at pump.

NOTE: Floating inlet not only device to accomplish drawing water from tank. Vertical piping may use foot valve and only requirement is water shall be drawn a minimum 4 in. from bottom of tank

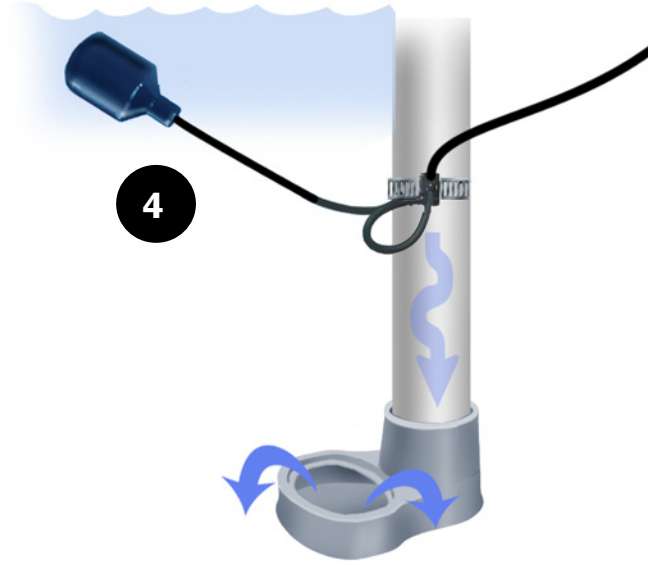

Calming inlet and mercury-free float switch.

3A

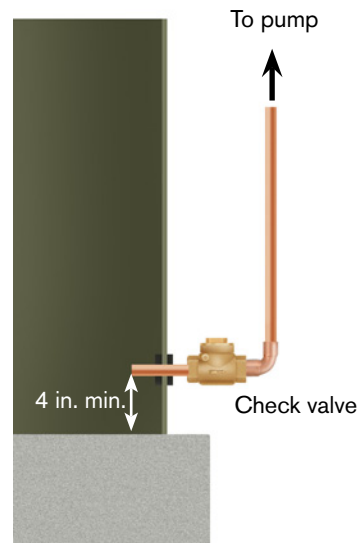

3B

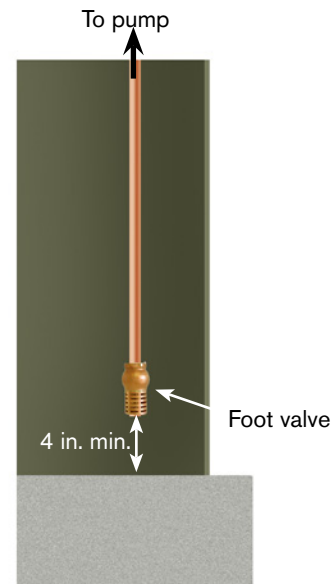

Underground Tank with Indoor Use & Drip Irrigation

Illustrations are for reference only, other components & designs are acceptable with the approval of Design Engineer and AHJ

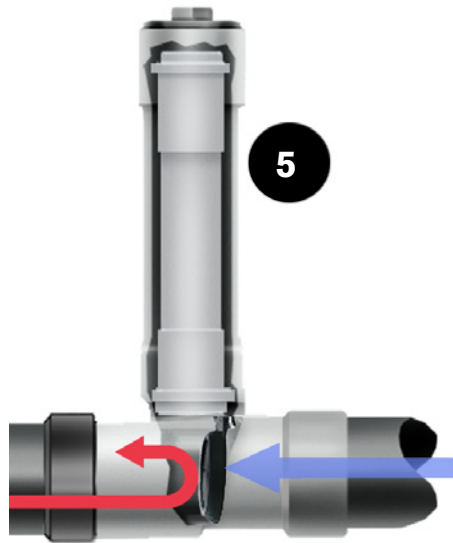

Backwater valve on tank overflow. Overflow pipe discharges to bio-swale, raingarden, infiltration device or other approved location. All exposed openings shall be screened with 1/8 in. screen mesh.

See detail example on p.5 for infiltration device

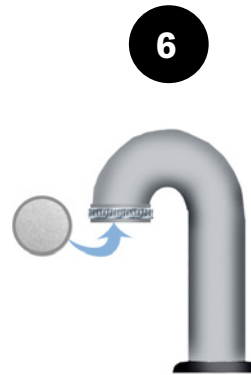

Vent with 1/8 in. or 3175 micron bug screen to prevent mosquitos and insects



Underground Tank with Indoor Use & Drip Irrigation

Illustrations are for reference only, other components & designs are acceptable with the approval of Design Engineer and AHJ

Infiltration Device

Choose filtration and sediment trap suitable for application

5A Infiltration Device

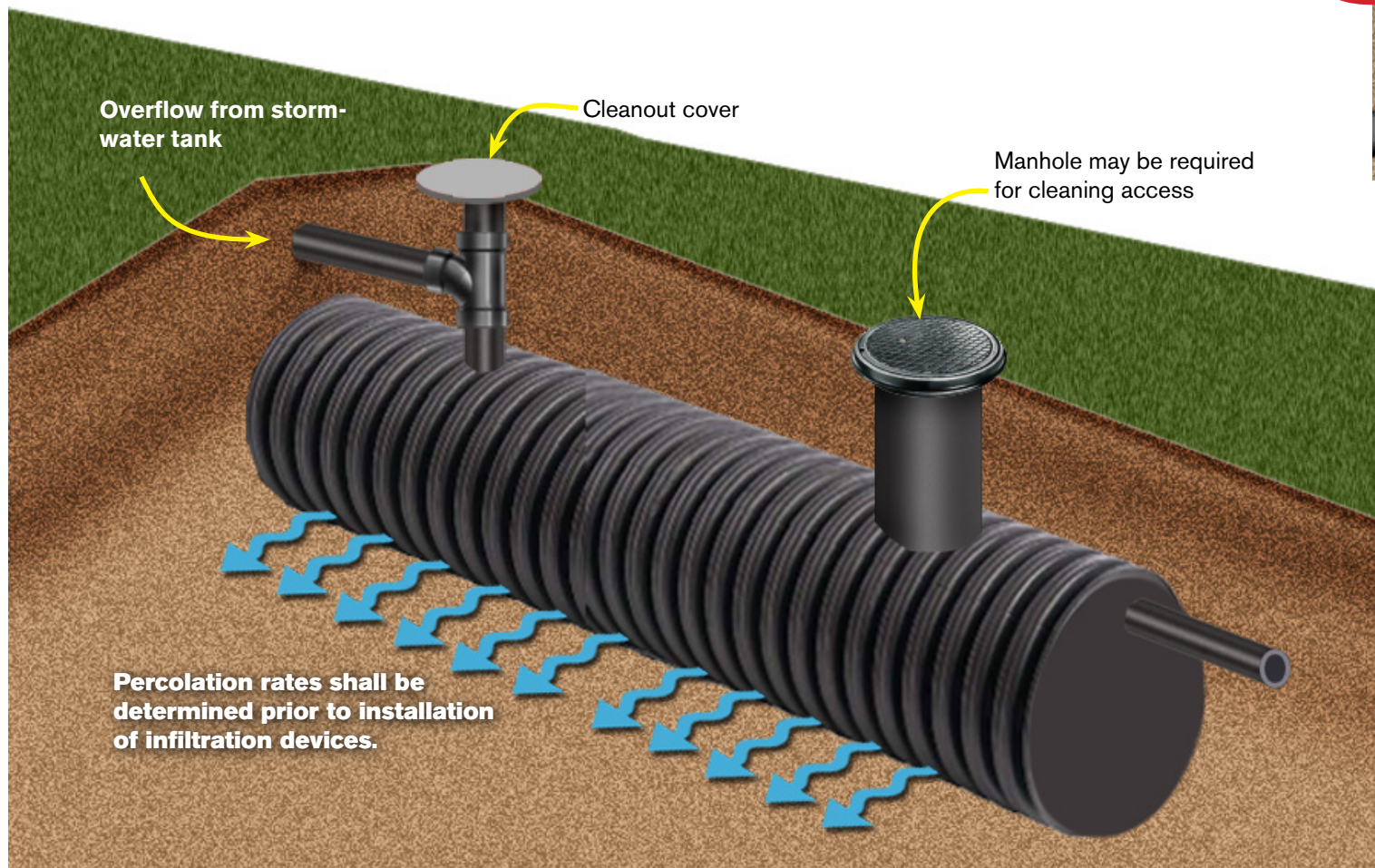

Sample sediment filtration prior to tank inlet

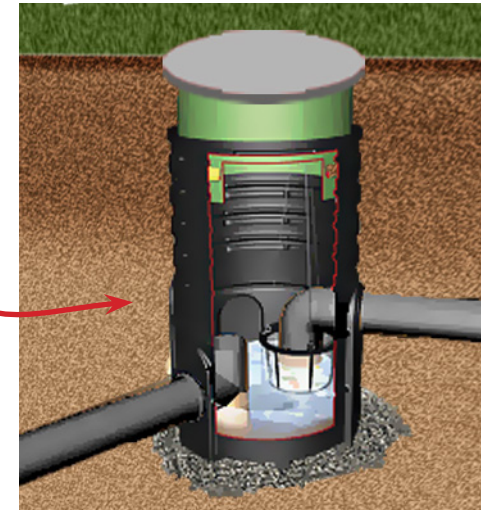

Underground Tank with Indoor Use & Drip Irrigation

Illustrations are for reference only, other components & designs are acceptable with the approval of Design Engineer and AHJ

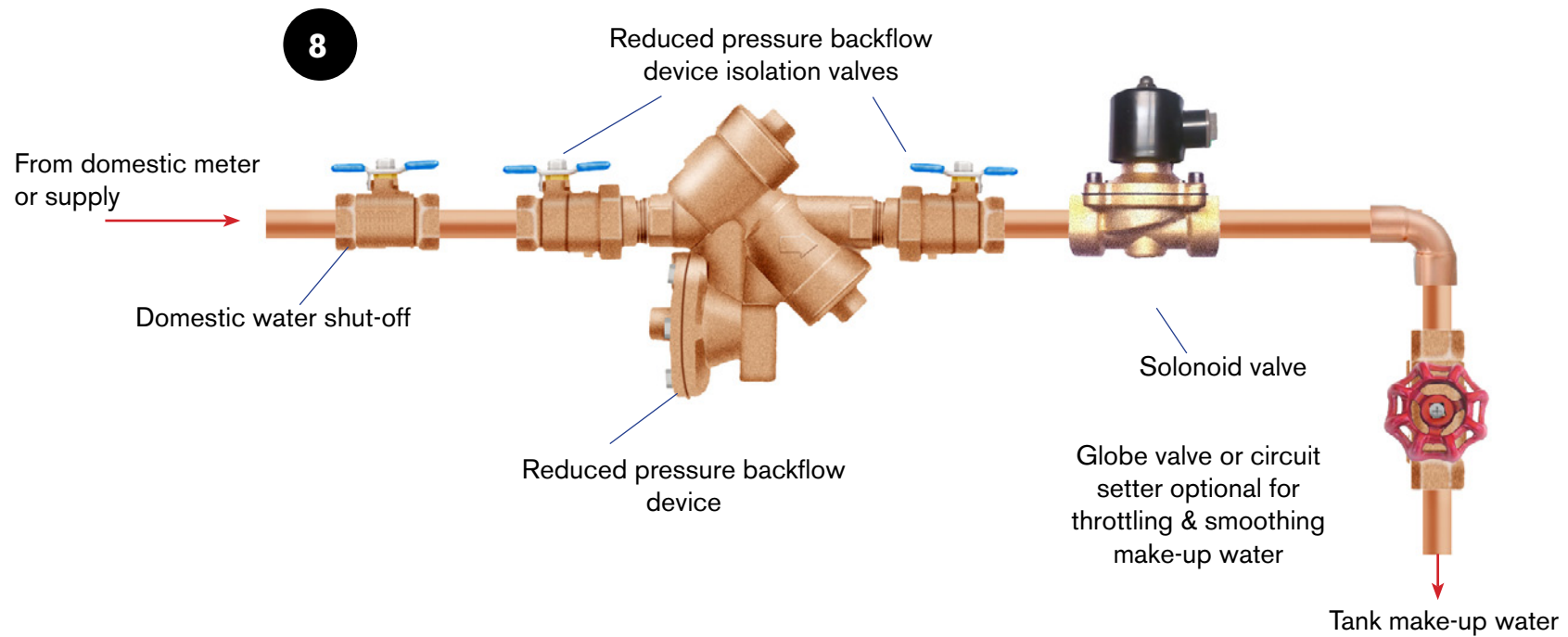

Air Gap Alternative 1

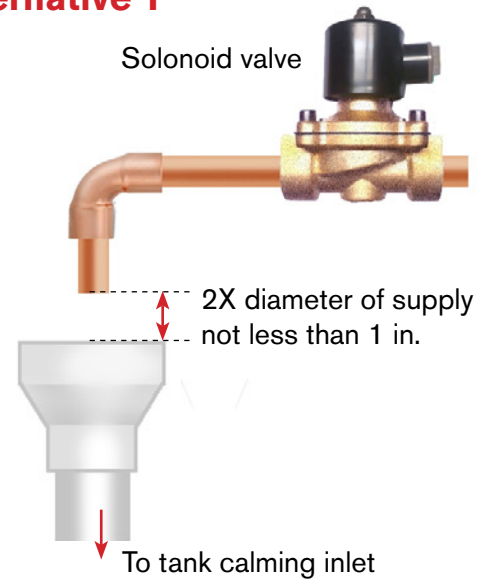

Underground Tank with Indoor Use & Drip Irrigation

Illustrations are for reference only, other components & designs are acceptable with the approval of Design Engineer and AHJ

Air Gap Alternative 2

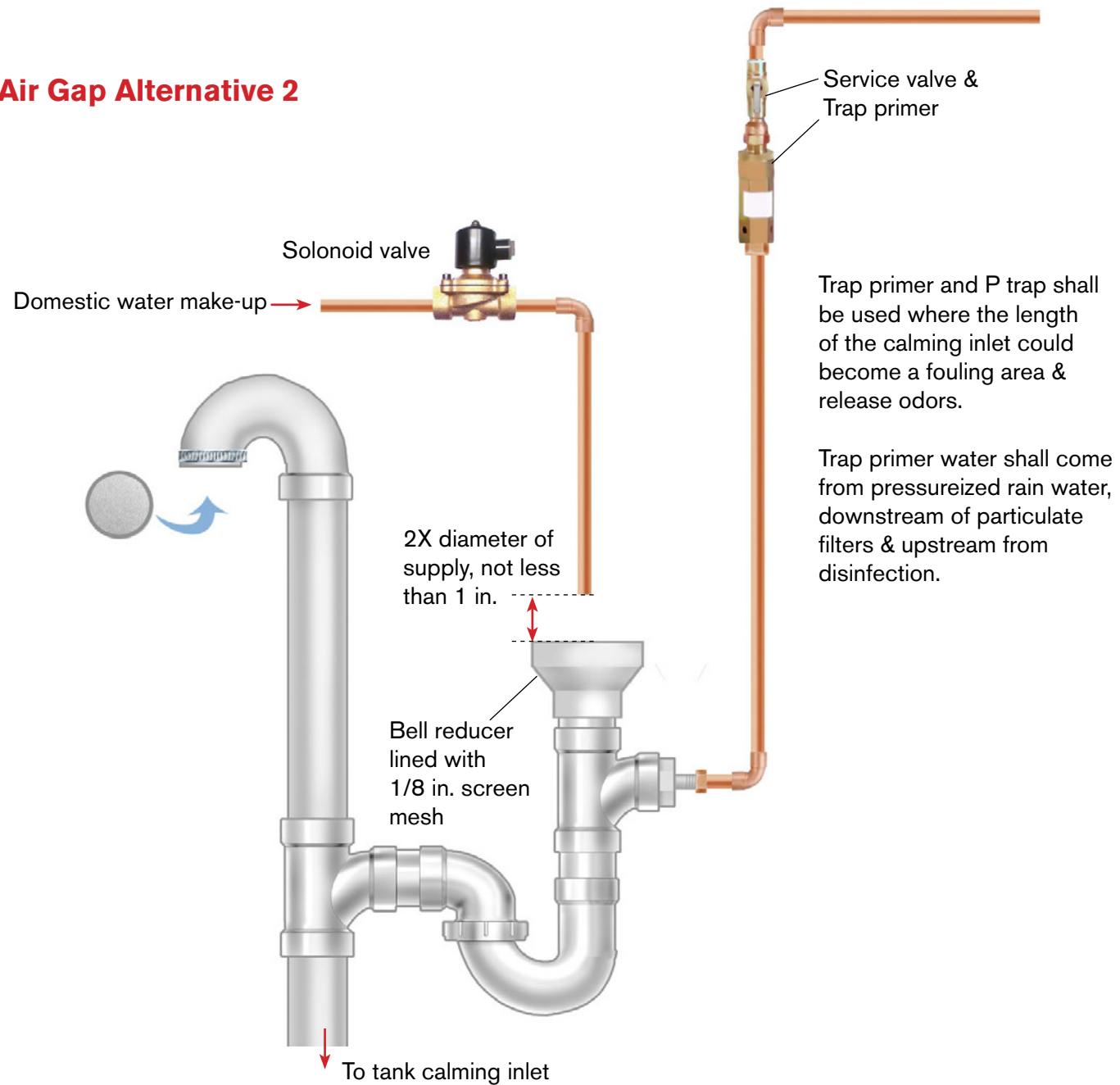

Underground Tank with Indoor Use & Drip Irrigation

Illustrations are for reference only, other components & designs are acceptable with the approval of Design Engineer and AHJ

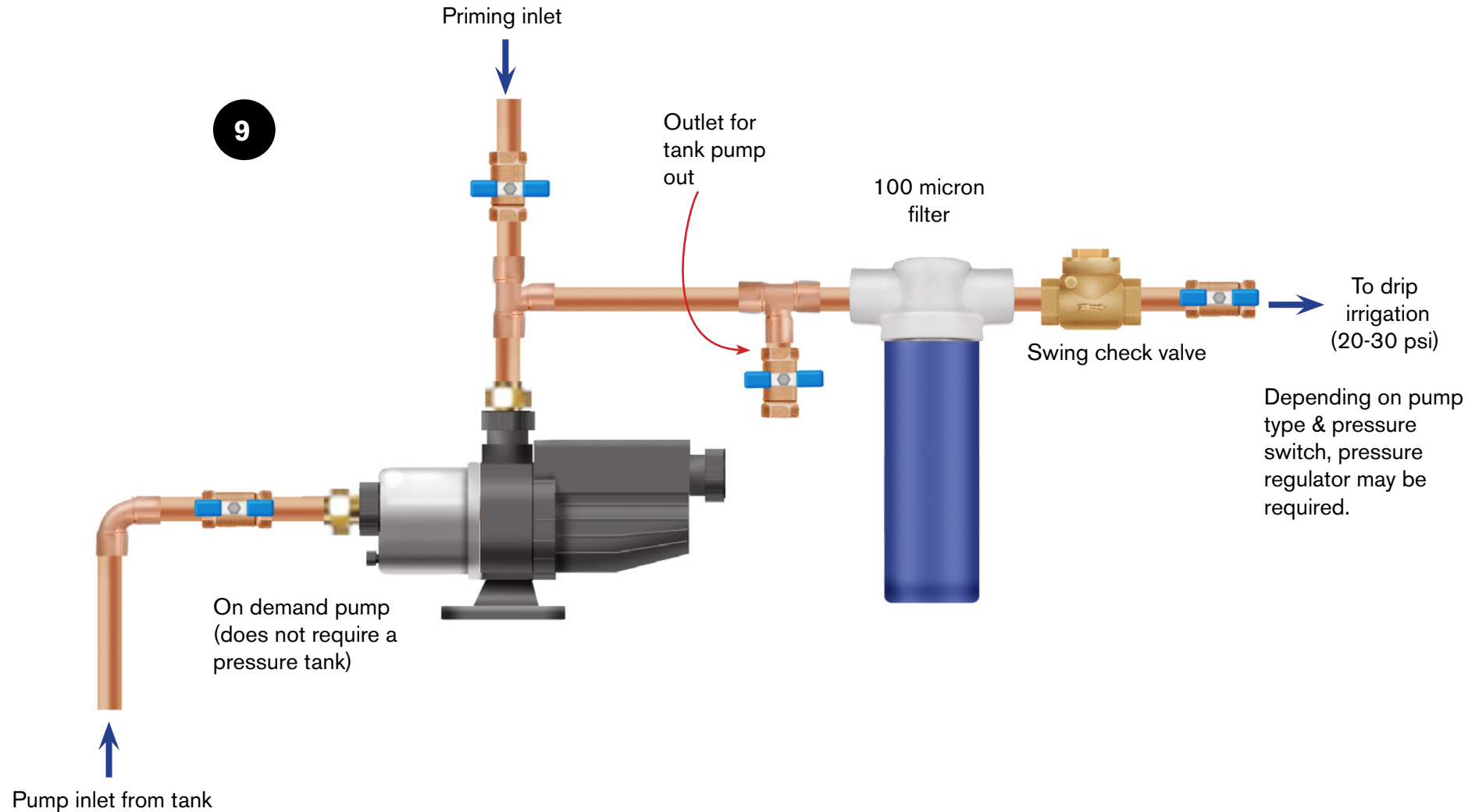

Underground Tank with Indoor Use & Drip Irrigation

Illustrations are for reference only, other components & designs are acceptable with the approval of Design Engineer and AHJ

